



SHOPCO Advantages

QUALITY

- All steel components in shelving units
- Dry powder epoxy coating - far superior to enamel paint
- Wire shelves have structural bar supports (not round rods) to prevent sagging, and high quality powder coat finish

VERSATILITY

- Permits merchandising options not available in other systems (especially with respect to sales counters)
- Can be dismantled and reassembled in different sizes and shapes with ease
- Custom designs and multiple uses are possible from standard components
- Inside corner, outside corner and curved shelving units open up new design possibilities
- Clip-on brackets offer more angle positions than traditional shelves with welded brackets
- Clip-on brackets permit shelves to be reversible
- Many color combinations are possible with standard panels

IMAGE

- High tech styling
- Color possibilities together with wire shelves and accent price rails yield an enhanced store image
- Colorful price ticket rails and/or glowing top covers offer new design elements not available with other systems

DESIGN AND LAYOUT

- Full service CAD department along with in-house showroom helps to develop new ideas and products as well as standardized packages
- Award winning designs - SHOPCO has been consistently recognized by industry leading publications for its award winning designs.

AVAILABILITY

- Large inventory of standard items to meet our customers' urgent needs (shortest lead time in the industry)

SHOPCO SPECIFICATIONS

SHOPCO U.S.A. INC.



Shelving Material

All the components of the SHOPCO merchandising system shall be fabricated of high quality heavy duty steel and coated in a multiple step process of electrostatically applied dry powder epoxy, and baked to achieve maximum hardness. The steel used to fabricate the shelving components shall be the following thickness:

Uprights	12 gauge
Brackets	10 gauge
Slat Wall Panels	18 gauge
Mini-Slat Wall Panels	18 gauge
Smooth (back) Panels	20 gauge
Pegboard Panels	20 gauge
Solid Shelves	20 gauge

MODULES

This product system offers various configurations. Four nominal lengths and two standard depths are available. Many different heights are available depending on the combination of standard panels used.

<u>Nominal Length</u>	<u>Standard Depths</u>	<u>Standard Nominal Heights</u>		
1 ft.	12 in.	32 in.	42 in.	72 in.
2 ft.	16 in.	34 in.	44 in.	80 in.
3 ft.		36 in.	53 in.	88 in.
4 ft.		38 in.	60 in.	96 in.
		40 in.	70 in.	107 in.

WIRE SHELVES

All wire shelves shall consist of 1/8 in. diameter wires, welded on 11/16 in. spacing, with 1/4 in. diameter longitudinal wires at the top of the front and back lips of the shelf. All wire shelves shall have 1 in. high and 12 gauge thick FLAT BAR longitudinal supports (positioned vertically and welded to the shelf ends) under the shelf to prevent bowing or sagging when the shelf is loaded with merchandise. Twelve inch deep and narrower shelves shall have at least two flat bar supports and fourteen inch and larger shelves shall have at least three flat bar supports. Wire shelf brackets shall be removable to permit the shelf to be reversible for maximum merchandising versatility. Wire shelves shall be adjustable to flat, 15 degree and 25 degree down slope angles. Steep angle brackets shall be available to be used on the same shelf permitting shelf settings of 50, 65, and 75 degree down slope angles.

<u>Nominal Length</u>	<u>Nominal Depth</u>		<u>Front Lip</u>
2 ft.	10 in.	16 in.	2 in.
3 ft.	12 in.	20 in.	4 in. (12 & 16 in. D shelves only)
4 ft.	14 in.	24 in.	



SHOPCO SPECIFICATIONS

SHOPCO U.S.A. INC.

Shelving Material

SOLID (FLAT) SHELVES

All solid/flat shelves shall be fabricated of 20-gauge steel with an additional longitudinal support for all sizes greater than 12 in. Solid shelves shall have a continuous groove along the front and back edge of the shelf for fencing (no holes in shelf surface). Solid shelves shall be adjustable to flat, 15-degree and 25-degree down slope angles.

<u>Nominal Length</u>	<u>Nominal Depth</u>	
2 ft.	10 in.	16 in.
3 ft.	12 in.	20 in.
4 ft.	14 in.	24 in.

LOADING CAPACITY

The shelving construction shall be designed to meet or exceed the following loading capacity, based on testing under conditions of total collapse with a safety factor of 2.0 and static, homogeneous load dispersion.

<u>SHELF TYPE</u>	<u>SHELF DEPTH</u>	<u>MAXIMUM LOAD</u>
Wire Shelves with Standard Brackets	8" Deep	154 lbs. (70 kg)
	10" Deep	154 lbs. (70 kg)
	12" Deep	154 lbs. (70 kg)
	14" Deep	132 lbs. (60 kg)
	16" Deep	110 lbs. (50 kg)
Solid Shelves with Standard Brackets	10" Deep	220 lbs. (100 kg)
	12" Deep	220 lbs. (100 kg)
	14" Deep	198 lbs. (90 kg)
	16" Deep	176 lbs. (80 kg)
Solid Shelves with Heavy Duty Brackets	12" Deep	385 lbs. (175 kg)
	14" Deep	352 lbs. (160 kg)
	16" Deep	352 lbs. (160 kg)
Solid Shelves Mounted on Feet with Base Brackets	12" Deep	418 lbs. (190 kg)
	16" Deep	418 lbs. (190 kg)

SHOPCO SPECIFICATIONS

SHOPCO U.S.A. INC.



Panels

All shelving units shall have metal smooth, metal pegboard, metal slat wall or metal mini-slat wall panels for enhanced aesthetic appeal and merchandising versatility.

Smooth

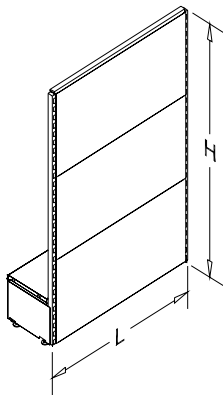

Nominal Length

1 ft.
2 ft.
3 ft.
4 ft.

Nominal Height

3.5 in. 10.5 in.
5 in. 12 in.
7 in. 18 in.
9 in.

Pegboard

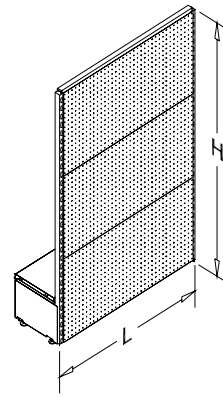

Nominal Length

1 ft.
2 ft.
3 ft.
4 ft.

Nominal Height

7 in.
9 in.
18 in.

Slat Wall

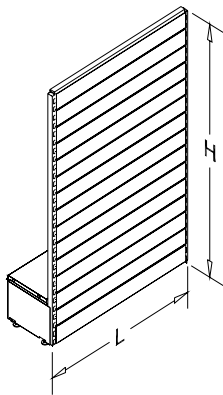

Nominal Length

2 ft.
3 ft.
4 ft.

Nominal Height

3.5 in.

Mini-Slat Wall

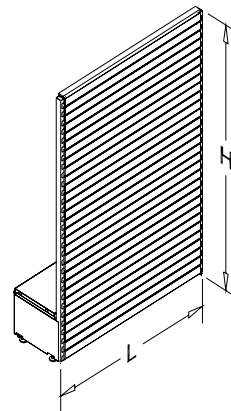

Nominal Length

2 ft.
3 ft.
4 ft.

Nominal Height

9 in.
18 in.



SHOPCO SPECIFICATIONS

SHOPCO U.S.A. INC.

Uprights

Uprights are produced from 2- 3/8" X 1- 3/16" and 1- 3/16" X 1-3/16" steel tubes, HR-3 quality, which is a micro-alloyed high strength steel. Vertical uprights are available in the standard module heights and can be custom cut to any length. Four types of uprights are available:

	<u>Size</u>	<u>Used For</u>
U-shaped Wallstrip	1- 3/16" in. L X 1- 3/16" in. D	Wall Cover Unit
4D Upright	1- 3/16" in. L X 1- 3/16" in. D	Sales Counters
2D Small Upright	1- 3/16" in. L X 1- 3/16" in. D	Wall Units/Specialty Units
2D Large Upright	1- 3/16" in. L X 2- 3/8" in. D	Gondola Units

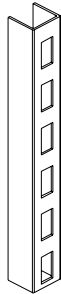

U-shaped Wallstrip



2D Small Upright

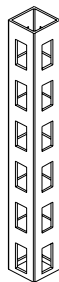

4D Upright



2D Large Upright

SHOPCO SPECIFICATIONS

SHOPCO U.S.A. INC.



Feet

Standard 8 in. foot attaches to upright during assembly for maximum versatility. The T-Foot and L-foot are welded to the upright, yet offer a lower height of 4 in.

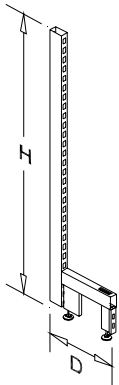

Standard Foot

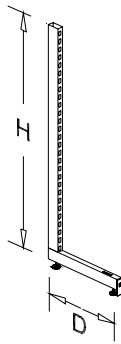

L-Foot

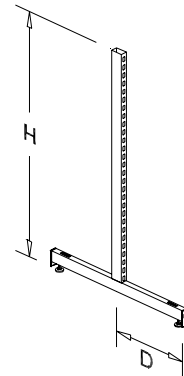

T-Foot

The T-Foot and L-foot are considered low profile bases. The low profile base is approximately 4 in. high, compared to the standard 8 in. base. The drawing below illustrates the difference in height.

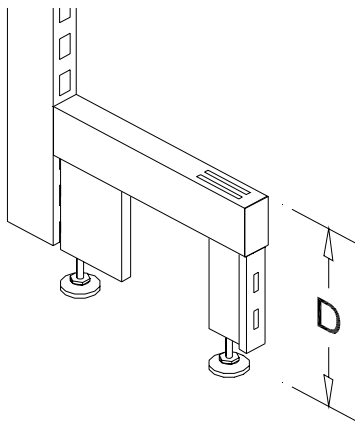

Standard Base

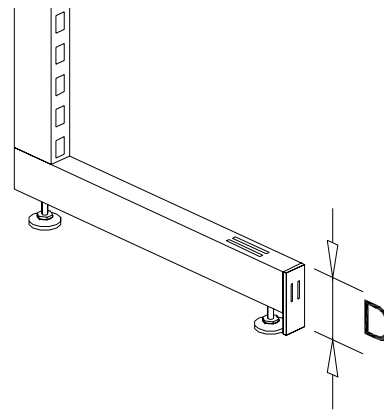

Low Profile Base



SHOPCO SPECIFICATIONS

SHOPCO U.S.A. INC.

Standard Shelving Length

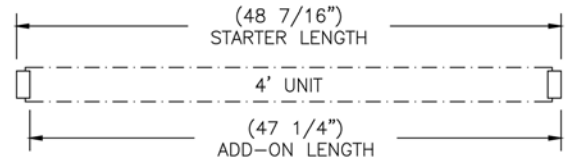
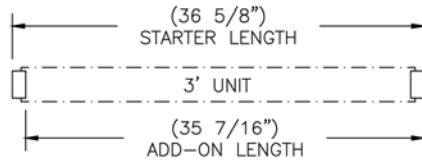
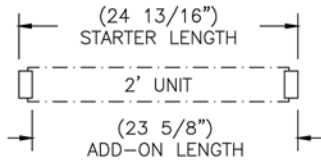

Standard Shelving Units: Standard Foot

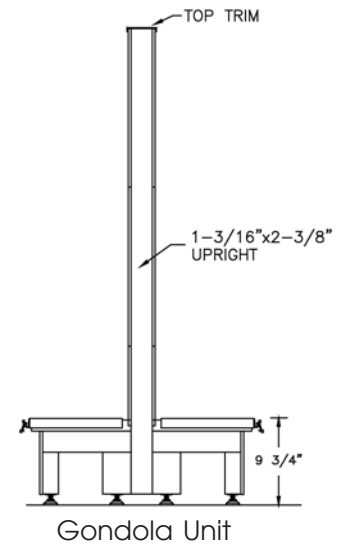
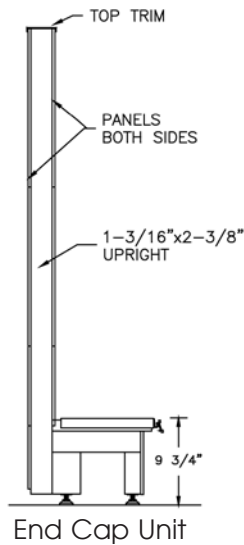
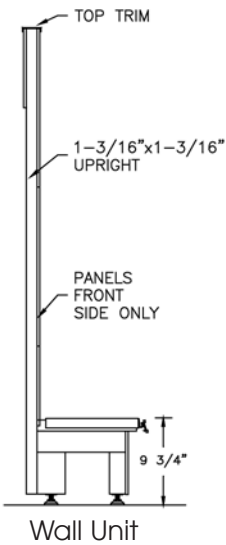

Standard Shelving Units: L and T Feet

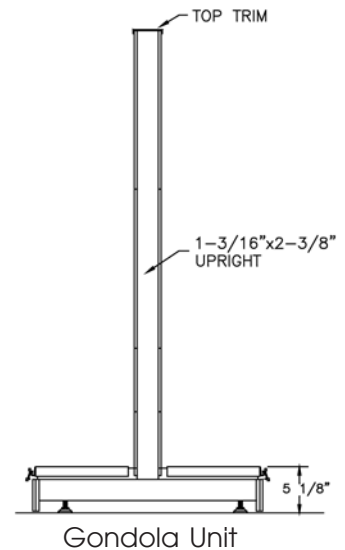
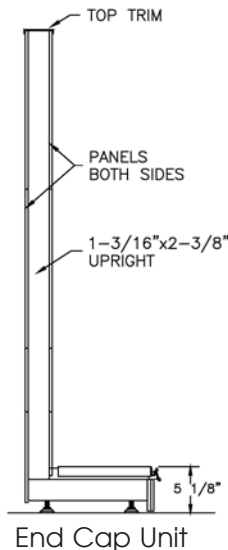
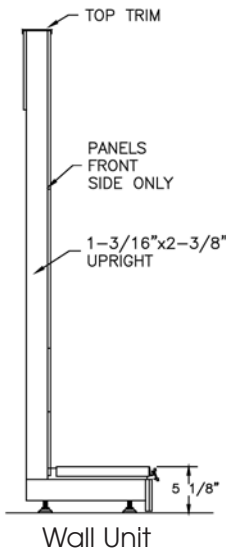

SHOPCO SPECIFICATIONS

SHOPCO U.S.A. INC.



Standard Curved Shelving Dimensions

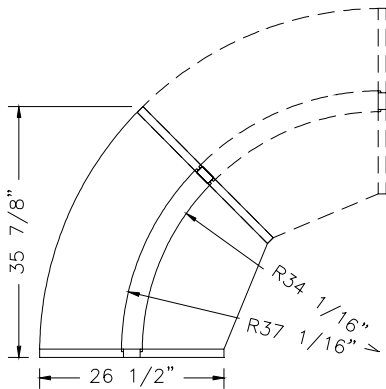
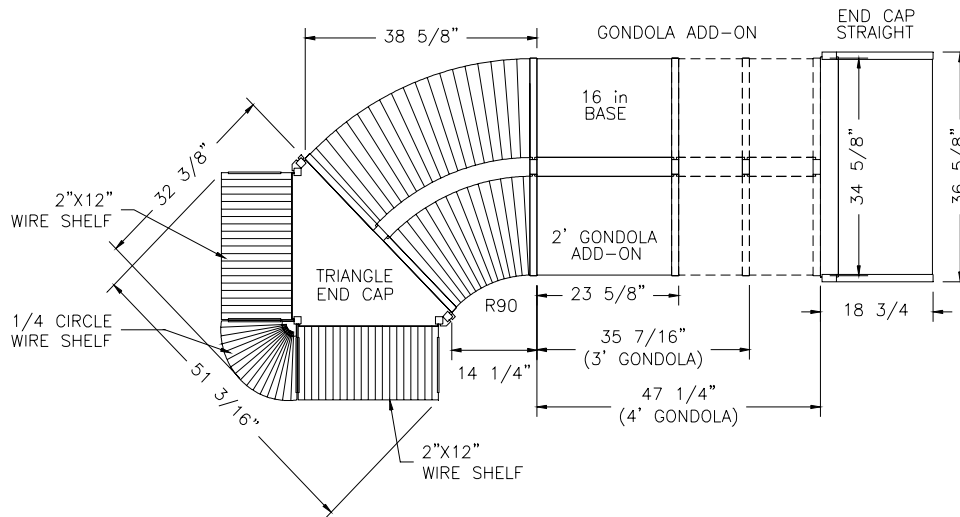

12 in. Base

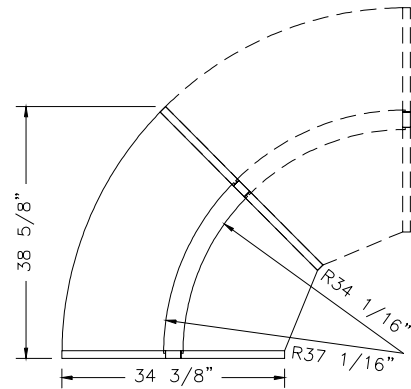

16 in. Base

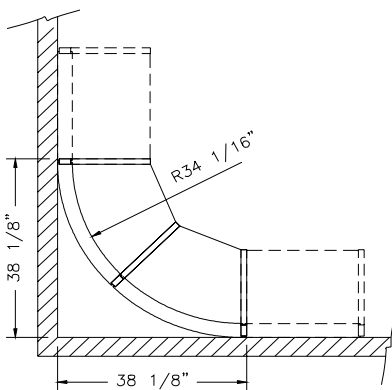

Inside Wall Unit

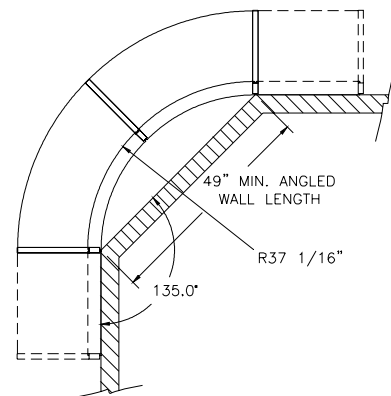

Outside Wall Unit



SHOPCO SPECIFICATIONS

SHOPCO U.S.A. INC.

Specialty Shelving Dimensions

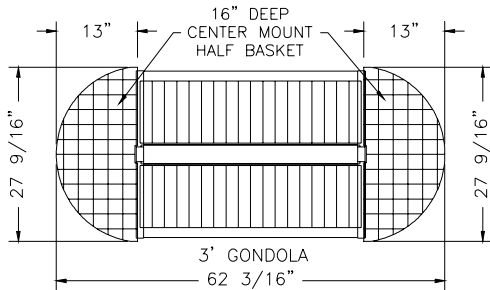

Wrap Unit

<12 in. Base

16 in. Base>

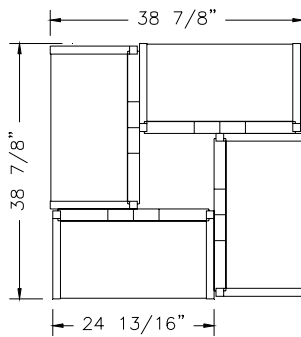
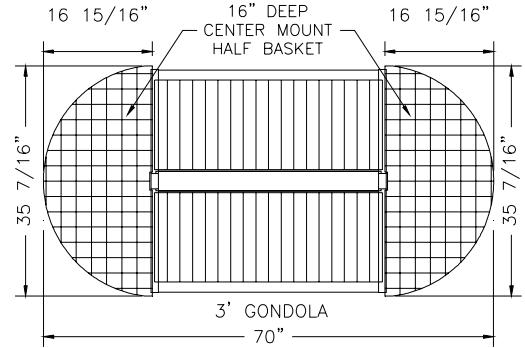

4-Way Unit

<2 ft. Sides - 12 in. Base

3 ft. Sides - 16 in. Base>

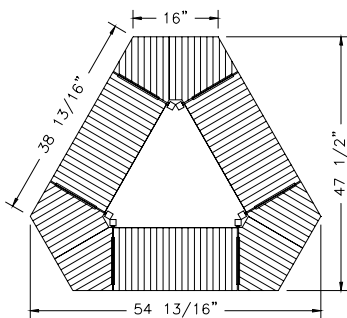
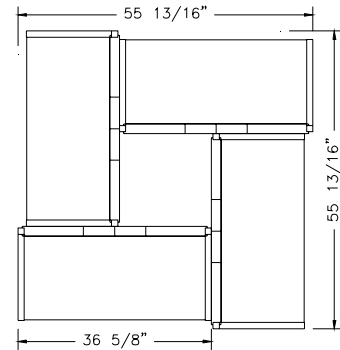

60 Degree Triangle Unit

<2 ft. Sides - 12 in. Shelves

3 ft. Sides - 12 in. Shelves>

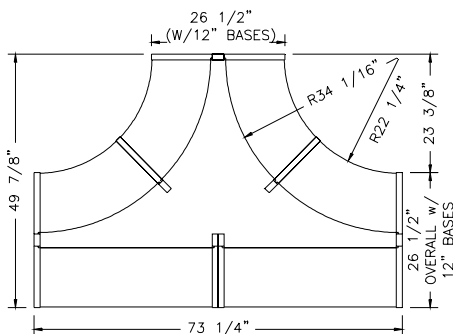
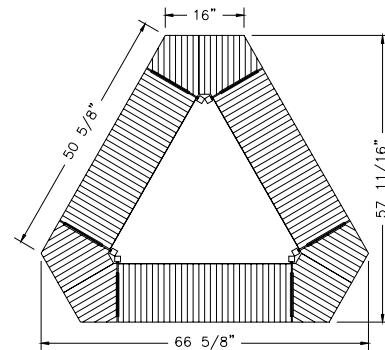

Split-T Gondola Unit

<12 in. Base

16 in. Base>

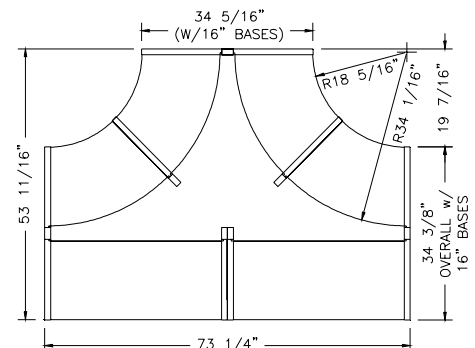

SHOPCO SPECIFICATIONS

SHOPCO U.S.A. INC.

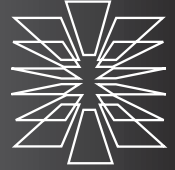

Color Chart

All shelving unit components, as well as wire and solid shelves are available in white, light beige and light gray. Base panels and feet are available in black, dark beige and dark gray. However, the T-Foot and L-Foot configurations are available in white and light gray. Top trims and price ticket rails are available in a wide variety of accent colors. These pieces and all shelving units can be custom powder coated for an additional price.

* SHOPCO color code numbers in parenthesis.

**Colors are approximate (printed ink will not match paint color exactly)

Standard Shelving Colors



Beige (15)



White (05)



Light Gray(70)

Standard Base Colors (kick plate & feet)



Dark Beige (13)



Black (08)



Dark Gray(90)

T-Foot and L-Foot Colors

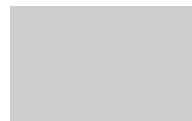

Light Gray (70)



White (05)

Standard Top Trim Colors



Black (08)

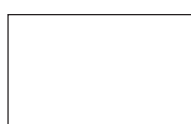

White (05)



Beige (15)



Light Gray (70)



Red (01)



Blue (12)



Yellow (03)



Green (29)

Standard Neon Colors

Glowing colors are designed to coordinate with the following powder coat colors: red, blue, yellow and green. However, they will not be an exact match.